

# Site Concept Plan

LEVEL 1

Project Site Area  
16,234 m<sup>2</sup>

Total Units  
802 units

No. of Storey  
 Tower A - 35 Storeys (197 units)  
 Tower B - 35 Storeys (272 units)  
 Tower C - 32 Storeys (177 units)  
 Tower D - 29 Storeys (156 units)  
 (Including 4 storeys of podium)



- |                         |                     |                     |
|-------------------------|---------------------|---------------------|
| 1 Guardhouse            | 6 Loading Bay       | 11 Community Corner |
| 2 Dropoff – Tower A & B | 7 Parcel Room       | 12 Jogging Path     |
| 3 Dropoff – Tower C & D | 8 Office            | ★ Lift Lobby        |
| 4 Mail Room             | 9 Car Parking       |                     |
| 5 Toilet                | 10 Butterfly Garden |                     |

# LE Parc-Place

PARKCITY HANOI

# Site Concept Plan

LEVEL **5**

Project Site Area  
16,234 m<sup>2</sup>

Total Units  
802 units

No. of Storey  
Tower A - 35 Storeys (197 units)  
Tower B - 35 Storeys (272 units)  
Tower C - 32 Storeys (177 units)  
Tower D - 29 Storeys (156 units)  
(Including 4 storeys of podium)



- |                      |                             |                           |                        |                    |
|----------------------|-----------------------------|---------------------------|------------------------|--------------------|
| 13 Stepping Garden   | 19 Lawn Pavilion            | 25 Pool Deck              | 31 Private Dining      | 37 Kid's Room      |
| 14 Sunken Garden     | 20 Changing Room with Sauna | 26 Swimming Pool Pavilion | 32 Pickle Ball Court   | 38 Resident Lounge |
| 15 Multipurpose Hall | 21 BBQ Deck                 | 27 Swimming Sunken        | 33 Children Playground | 39 Library         |
| 16 Yoga Deck         | 22 Social Lounge            | 28 Island Garden          | 34 Viewing Deck        | 40 Mini Theater    |
| 17 Gym + Yoga        | 23 Jacuzzi                  | 29 Tropical Lagoon        | 35 Golf Simulator Room | 41 Pavilion        |
| 18 Event Lawn        | 24 Lap Pool                 | 30 Kid's Pool             | 36 Games Room          | ★ Lift Lobby       |

# LE Parc-Place

PARKCITY HANOI

For market study purposes & internal use only. All dimensions, floor areas, and information/pictures presented within this informational kit are subject to further revision.

**DRAFT**

# Site Concept Plan

LEVEL **15**

Project Site Area  
16,234 m<sup>2</sup>

Total Units  
802 units

No. of Storey  
 Tower A - 35 Storeys (197 units)  
 Tower B - 35 Storeys (272 units)  
 Tower C - 32 Storeys (177 units)  
 Tower D - 29 Storeys (156 units)  
 (Including 4 storeys of podium)

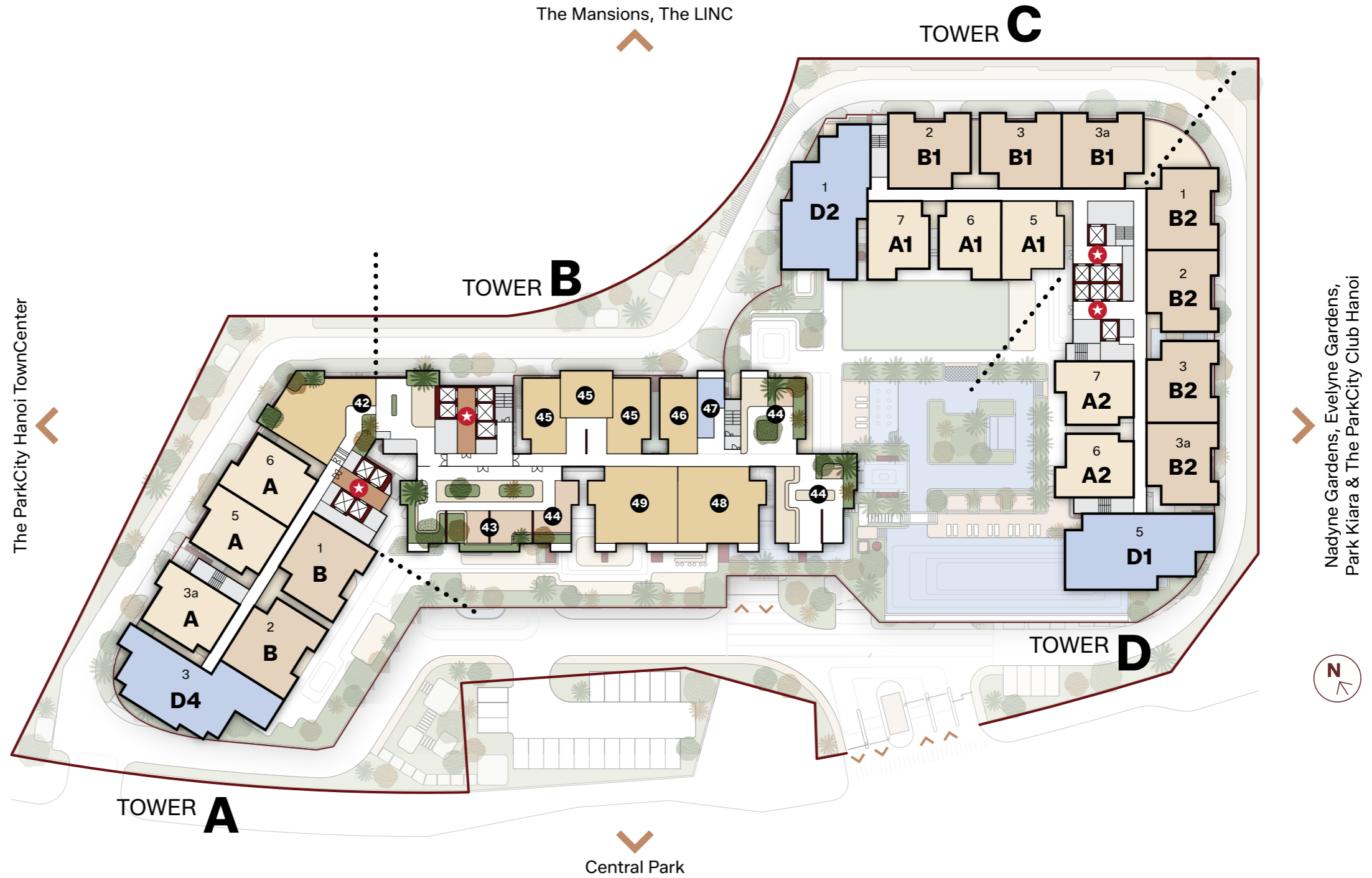

- 42 Refugee Area
- 46 Cooking Class
- ★ Lift Lobby
- 43 Viewing Deck
- 47 Toilet
- 44 Reading Area
- 48 Wine & Cigar
- 45 Private Studio
- 49 Study Rooms & Co Working

# LE Parc-Place

PARKCITY HANOI

For market study purposes & internal use only. All dimensions, floor areas, and information/pictures presented within this informational kit are subject to further revision.

**DRAFT**